

# Welcome

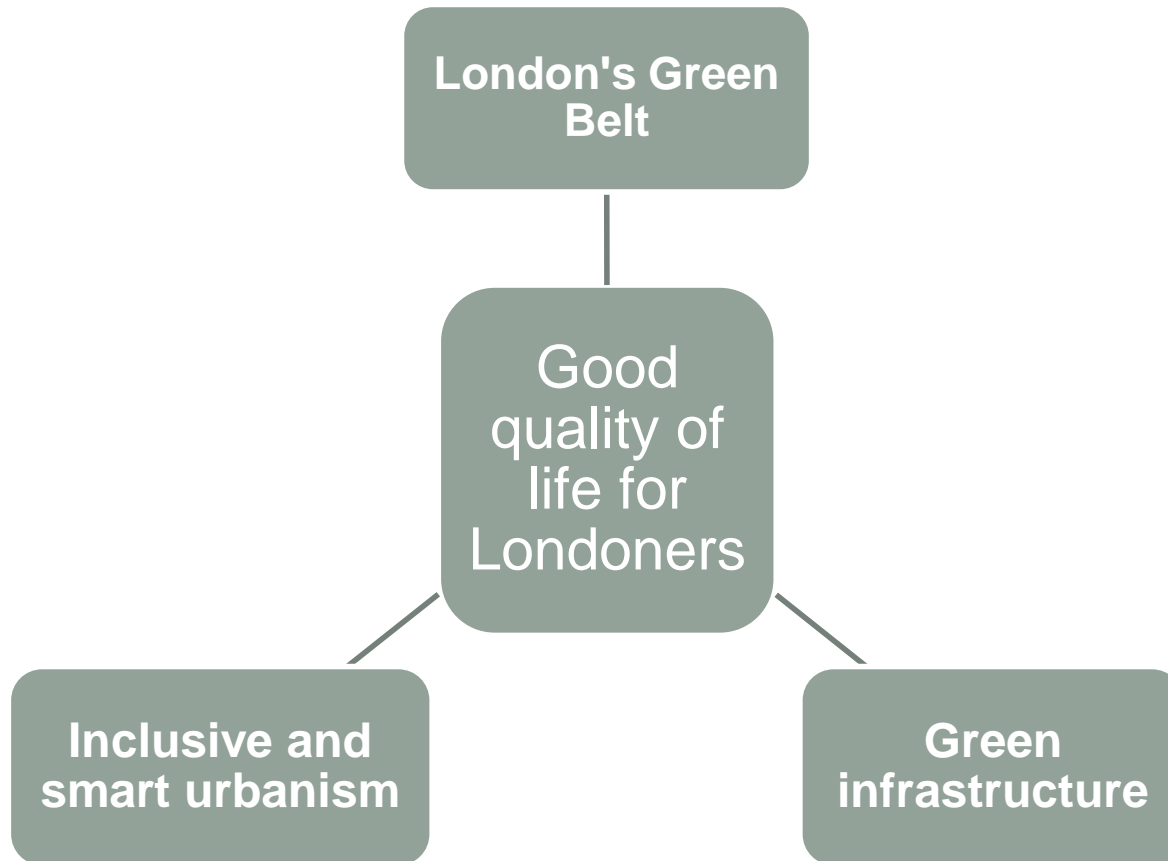

# CPRE London objectives



# Activities



Communications  
and resources

Policy analysis  
and response

Local planning  
support

# Campaign for a *Liveable London*

Objective: *To promote sustainable, compact and inclusive communities in response to London's housing crisis*

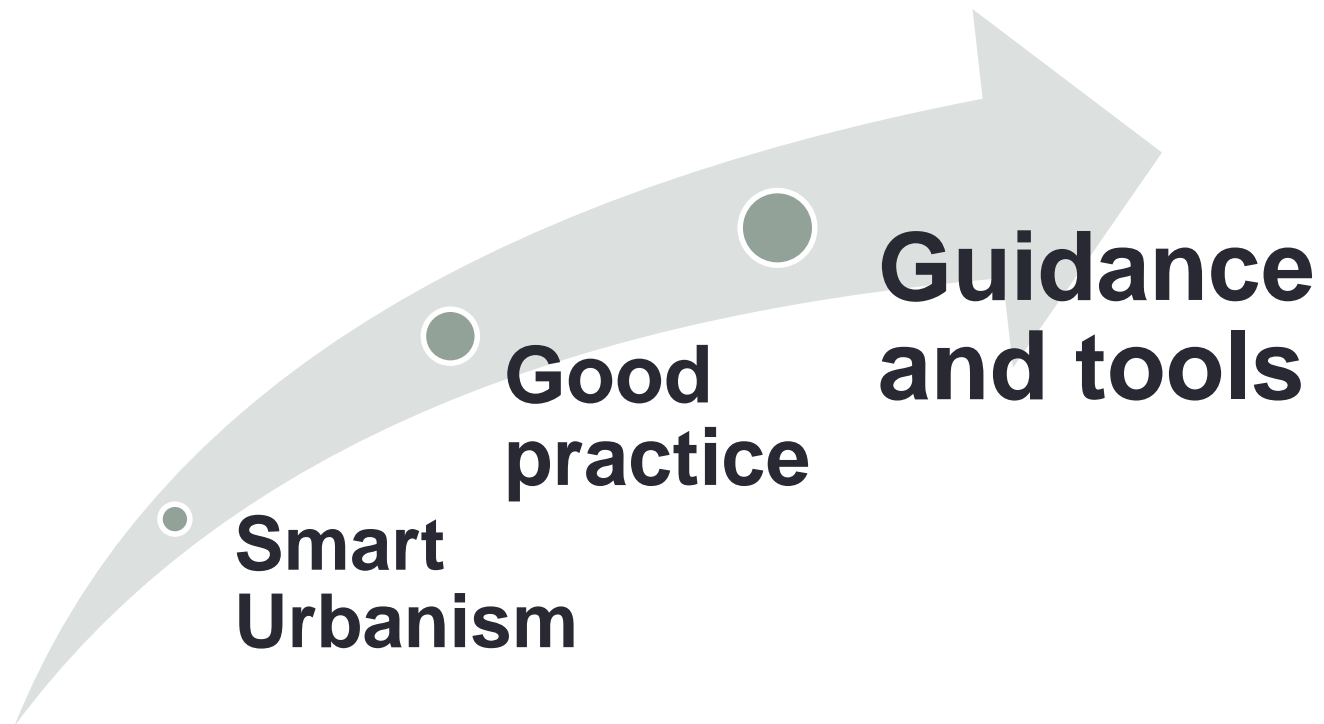

# Three challenges

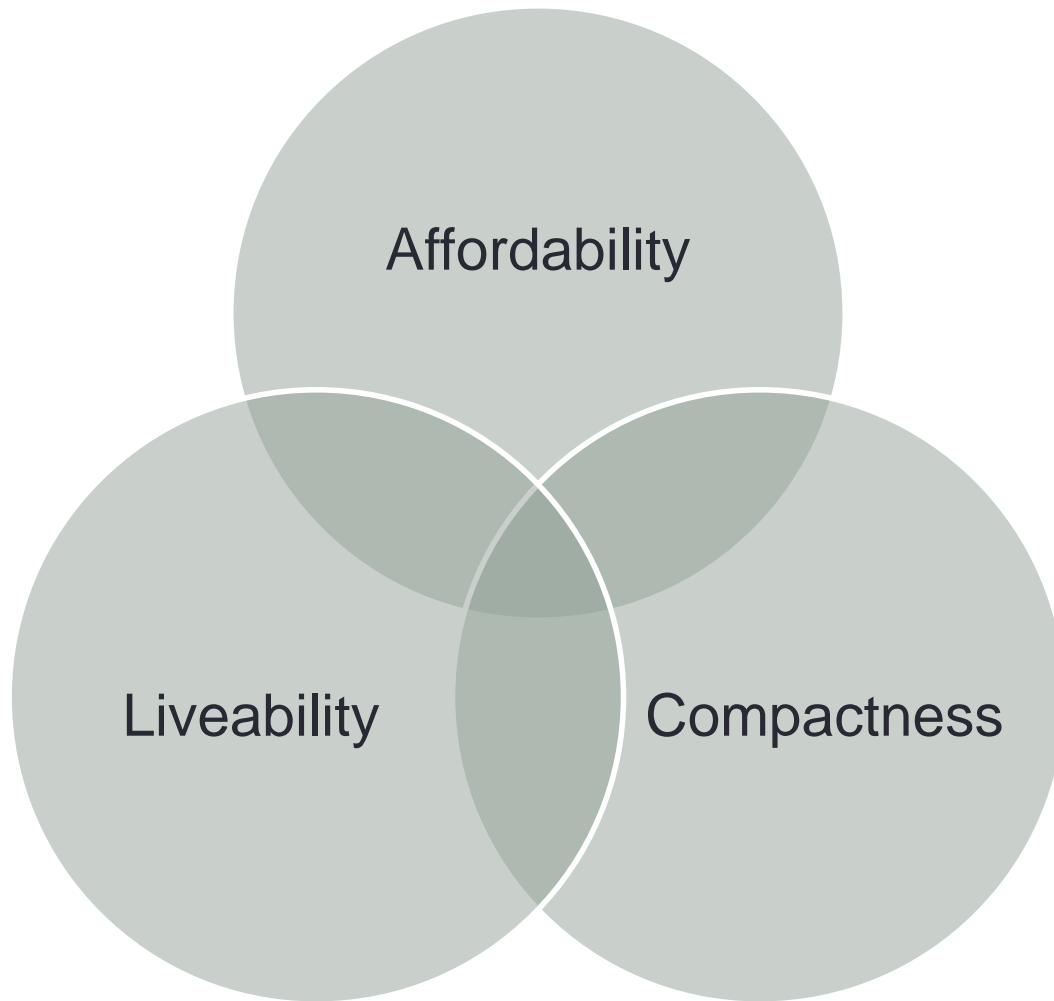

# Liveability? Life satisfaction



# Liveability? Standards



# Compact communities

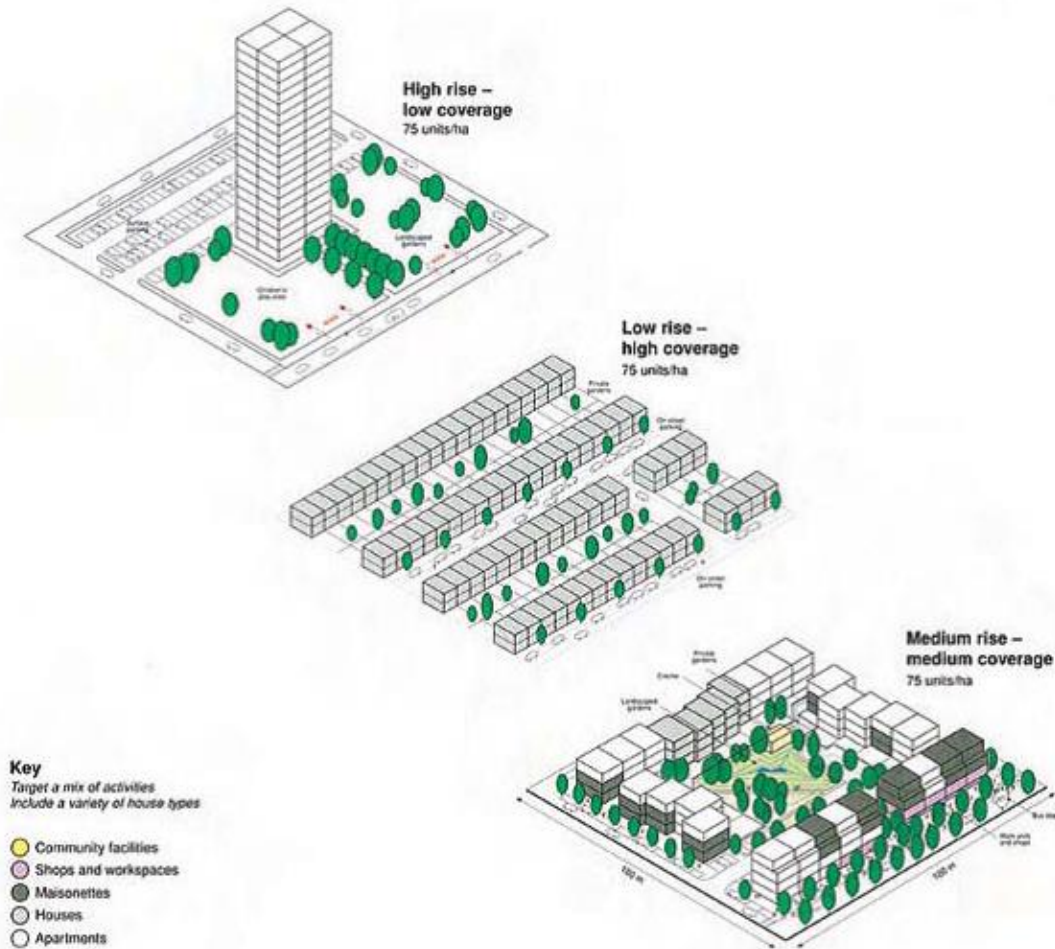

These three very different architectural forms are built to exactly the density  
(c) Andrew Wright Associates



# Affordability?

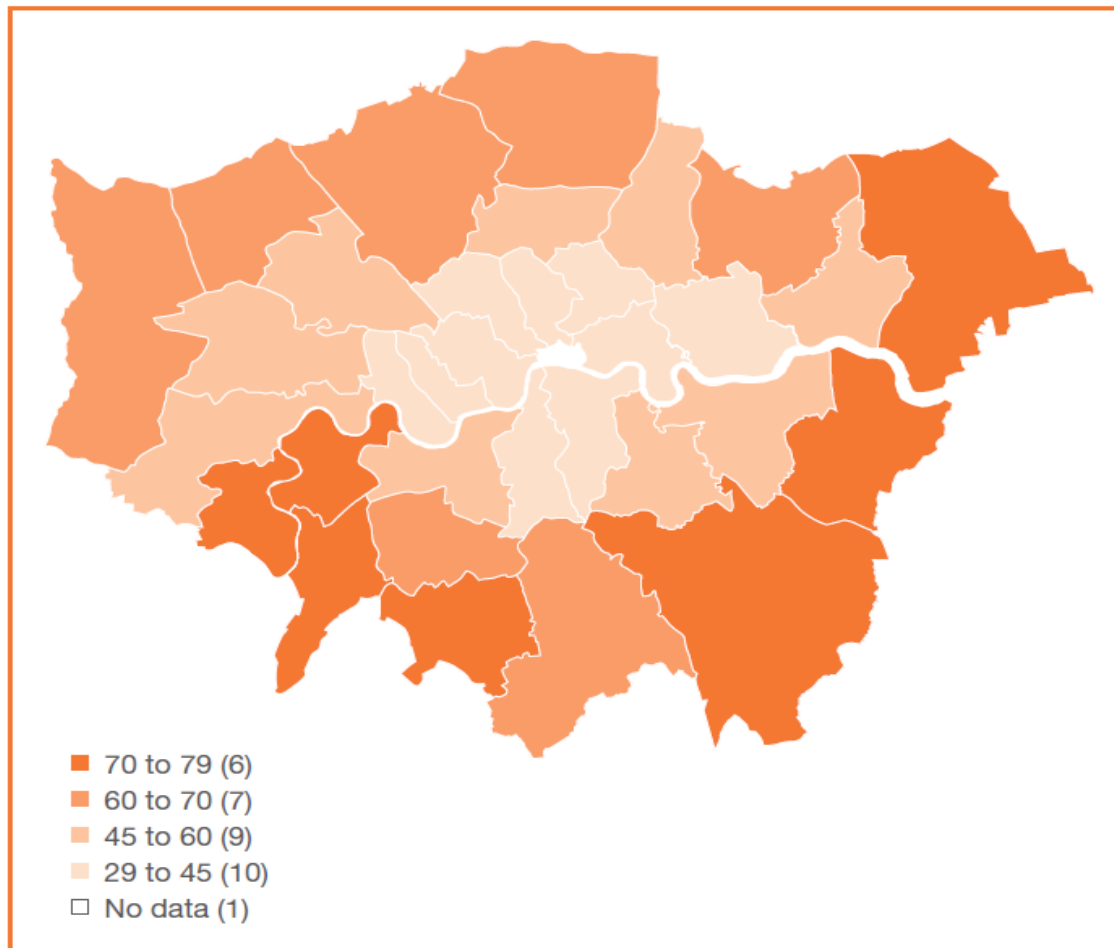

Source: Gleeson 2011

# Affordability?

**Number of households on London Boroughs' waiting lists,  
1997-2012 (DCLG 2013)**

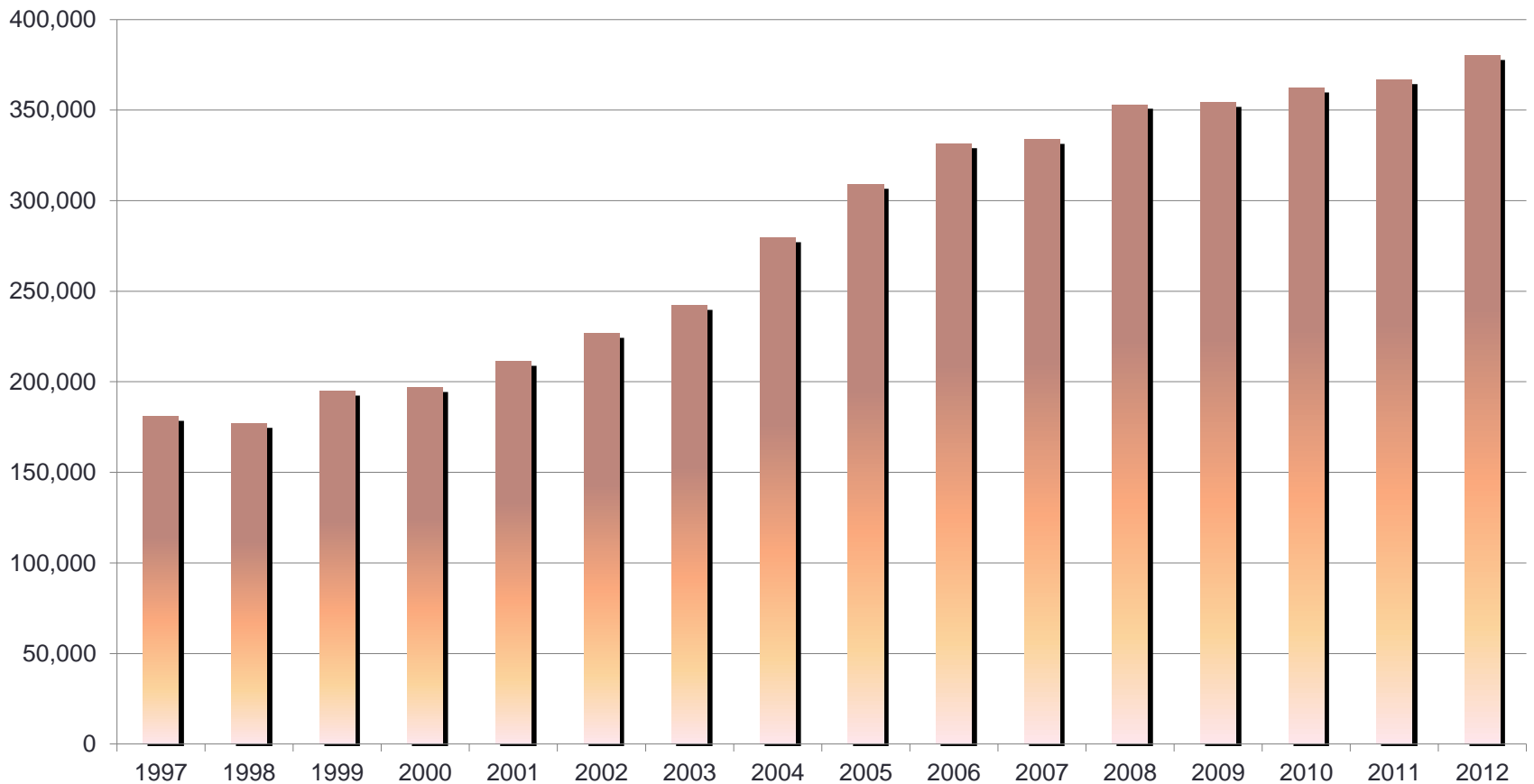

# *Unlocking Liveability* workshop

Housing – affordability and under supply

Wellbeing – Access, silo-thinking, resilience

Space / public realm – access, inflexible design,  
access, market failure

Transport – car vs bikeability & walkability,  
wellbeing links

Community / neighbourhood – social potential,  
opportunities to engage

# Case studies

1. Developer-led masterplans
2. Strong urban centres, infill & high street
3. Established estates & regeneration



# Outputs

- Practitioner guidance
- Policy recommendations
- Community resources

# Outcomes

- London Plan revision
- Practitioner & developer cooperation with local actors
- Community engagement in / ownership of developments



Further info: [www.cprelondon.org.uk/projects](http://www.cprelondon.org.uk/projects)